

The color temperature switch and photocell on/off switch can be adjusted to the desired value during production:

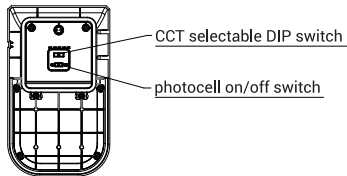

WARRANTY:

3-YEAR WARRANTY
If this product fails to perform satisfactorily due to a defect or poor workmanship within three years from the date of purchase, return it to the place of purchase and it will be replaced, free of charge. Incidental or consequential damages are excluded from the warranty.

TESTED COMPATIBILITY LIST OF TRIAC DIMMER:

Serial number	Brand	Model number
1	LUTRON	PD-6WCL
2	LUTRON	MSCL-00P153M
3	LUTRON	AY-603P
4	LUTRON	TGCL-153PH
5	LUTRON	AYCL-153P

LED Mini Wall Pack

Installation Instructions

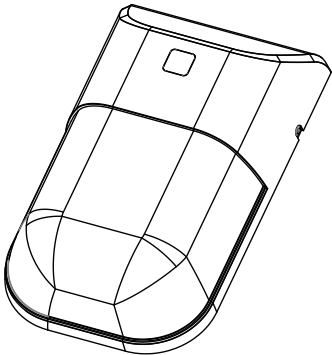

15W /20W

ACCESSORY KITS:

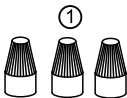

- ① P3 terminal*3
- ② PA4*20screw *4

DIMENSIONAL DRAWING:

Unit: mm/inch

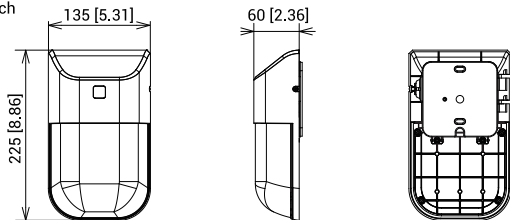

SAFETY INSTRUCTION:

- This fixture must be wired in accordance with the international electrical code and applicable local codes and ordinances.
- Proper grounding is required to ensure personal safety. Carefully observe the correct grounding procedure under the installation section.
- Make sure the power is off before installing or maintaining the fixture.
- Check that voltage is compatible with the fixture driver, use approved connectors for all electrical connections.

IMPORTANT: READ CAREFULLY BEFORE INSTALLING FIXTURE, RETAIN FOR FUTURE REFERENCE.

CLEANING:

1. Before touching the fixture, make sure the fixture is cooling.
2. Do not clean or maintain while the fixture is energized.
3. Clean the lens & fixture with a non-abrasive glass cleaning solution.
4. Do not open the fixture to clean and touch LED chips.

MAINTENANCE CAUTION:

1. Review the diagrams before beginning, and make sure the fixture is grounded properly.
2. Turn the power off and wait for fixture cooling to operate.
3. This fixture must be installed or maintained by the application code by a professional person familiar with the product's construction and operation and the hazards involved.

WIRING INSTRUCTION:

WARNING: TURN OFF POWER BEFORE CONNECTING WIRES.

Black wire connect to L, White wire connect to N, Green wire connect to GROUND.

Triac dimming:

1. Turn off the power.
2. Connect the BLACK wire with the LINE.
3. Connect the WHITE wire with the COMMON.
4. Connect the GREEN wire with the GROUND.

LINE	⚡ BLACK	LIGHT FIXTURE
COMMON	⚡ WHITE	
GROUND	⚡ GREEN	

INSTALLATION:

Tools: Phillips head screwdriver and electrical wiring tools.

1. Take out the fixture and loosen the housing side screws.



2. Mount the housing back plate to the wall and secure it with screws.

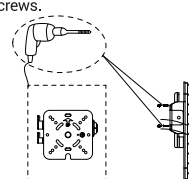

3. Mount the housing cover to the housing back plate.

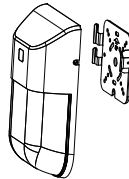

4. Connect the wires using wire connectors according to NEC and local codes.

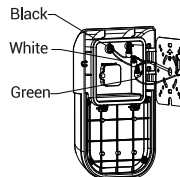

5. Tighten the screws with a manual screwdriver. If using an electric screwdriver, the recommended torque value is less than 5 (N.M).

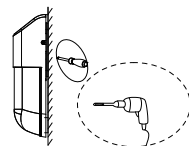

6. Apply weatherproof silicone sealant between the wall and fixture housing to ensure a weatherproof installation.

