

# LED LINEAR LIGHT USER GUIDE

## Splicing installation for suspension

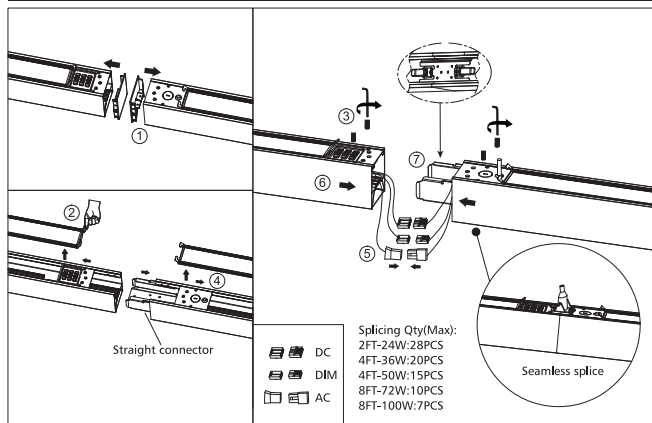

## Splicing installation for surface mounted and recessed

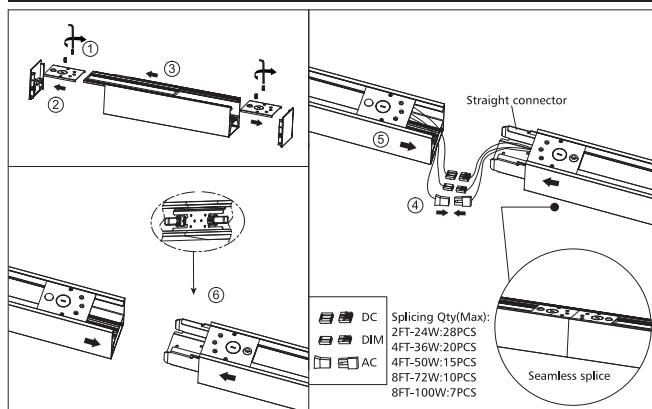

## Straight "L"

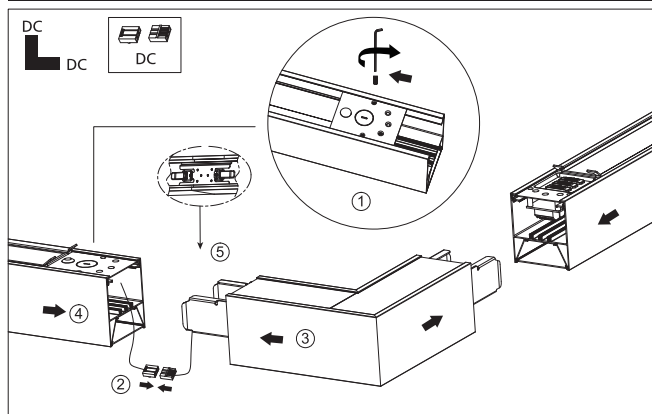

## Straight "+"

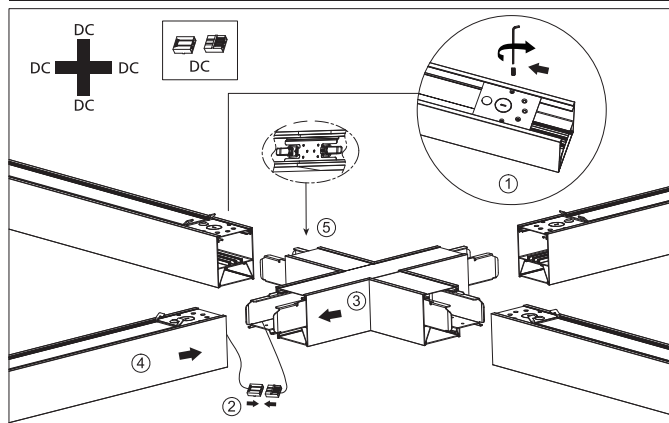

## Straight "T"

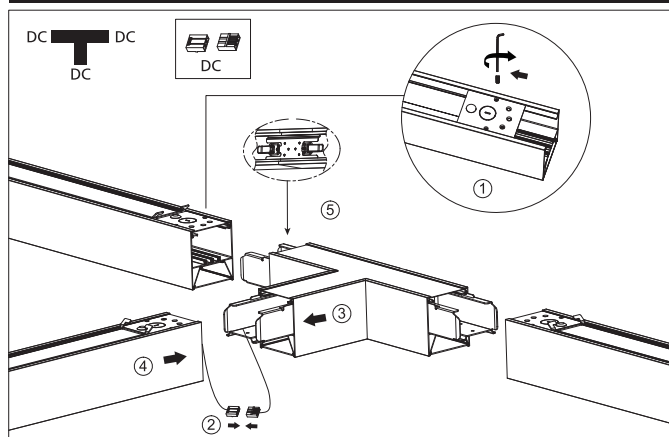

## Cover installation

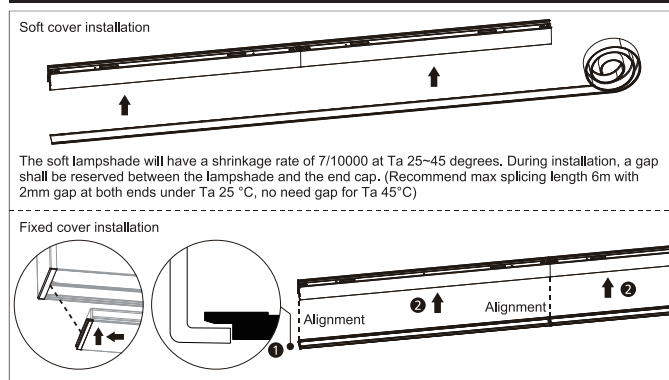

## Safety Instructions

To ensure correct function and safety, please read and follow all instructions carefully before using the product:

1. Turn off power before installation or before doing any maintenance work.
2. Do not install any luminaire near the heat source.
3. Do not exceed the nominal supply voltage or amperage ratings.
4. Dimmable version could be compatible with a wide range of recommended 0-10V dimmers.
5. All wiring and installation of the light fitting must adhere to local and national wiring rules.
6. Take care not to pull any electrical wires during unpacking as this may damage the connection.
7. Lay out all the components on a smooth surface and make sure there are no components missing before assembling.
8. To avoid injury or damage to the fitting, please ensure that power leads and screws are secure before connecting the power.
9. Please keep instructions for future reference.

## Installation Procedure

### WARNING

1. Switch off before installation.
2. Switch on only after complete installation and examination of the circuit.
3. Professional electrician for installation and maintenance only.

Turn Off power supply before starting any installation. Read instructions & check you have all the tools & accessories to complete the installation correctly.



## Color Temperature & Light Distribution Field Adjustable Controls

- Light Direction is selectable from Down only, Up only or both Down & Up lights.
- Up 100%+Down 0%, Up 70%+Down 30%, Up 50%+Down 50%, Up 30%+Down 70%, Up 0%+Down 100%, five lighting distribution ways switchable.
- Control CCT of down or up light individually. Switch from 3500K, 4000K & 5000K, or other customize color temperature range.
- Unique end cap simplifies installation, seamless continuous runs or individuals.

**!** Do not operate with power on.  
Please turn off the power when adjusting  
the power or color temperature.

CCT Switchable  
3500/4000/5000K

Uplight Downlight

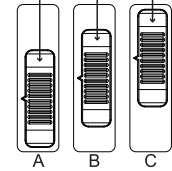

### Adjustable Light Distribution

- UP: 100% & DOWN: 0%
- UP: 70% & DOWN: 30%
- UP: 50% & DOWN: 50%
- UP: 30% & DOWN: 70%
- UP: 0% & DOWN: 100%

## Suspension installation with square surface plate.

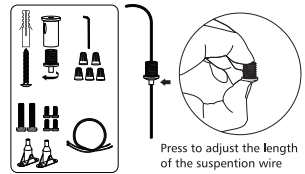

Press to adjust the length  
of the suspension wire

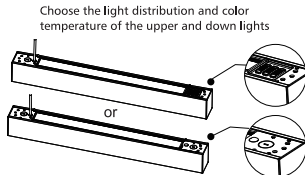

Single CCT and single power, not available to select.

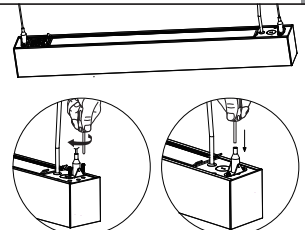
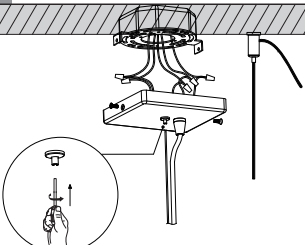
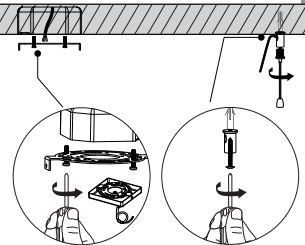

Insert the wire rope into the metal fixator

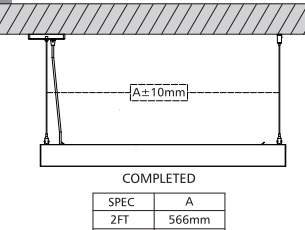

### COMPLETED

SPEC	A
2FT	566mm
4FT	1175mm
8FT	2394mm

## Suspension installation with round surface plate.

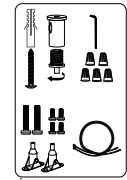

Press to adjust the length  
of the suspension wire

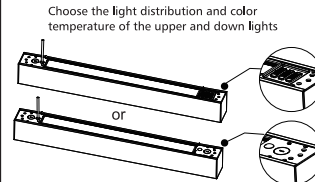

Single CCT and single power, not available to select.

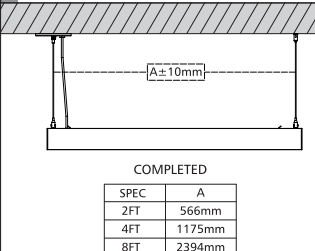
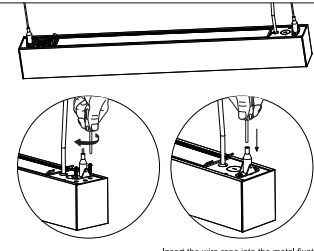
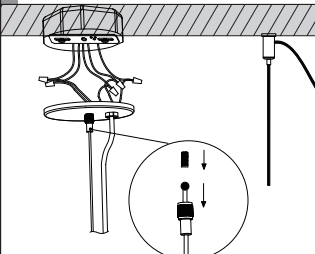
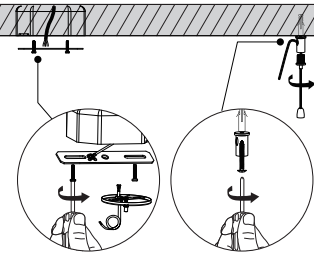

Insert the wire rope into the metal fixator

### COMPLETED

SPEC	A
2FT	566mm
4FT	1175mm
8FT	2394mm

## Recessed installation

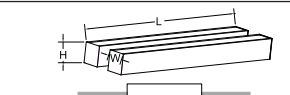
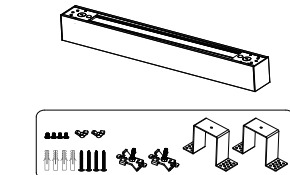

SPEC	(L)Length	(W)Width	(H)Height
2FT	610mm	67mm	76mm
4FT	1219mm	67mm	76mm
8FT	2438mm	67mm	76mm

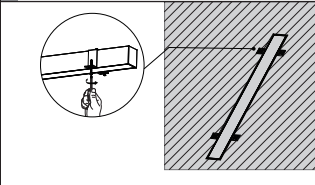
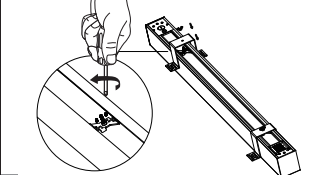

## Wall mounted installation

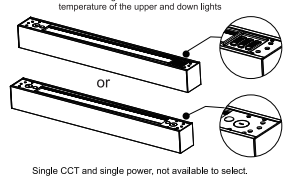
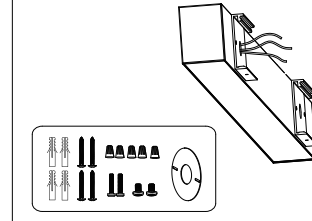

Single CCT and single power, not available to select.

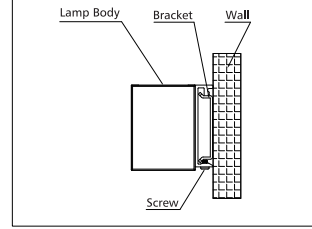
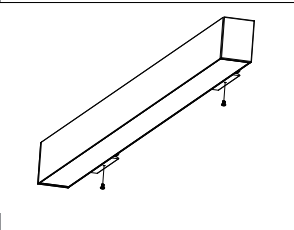
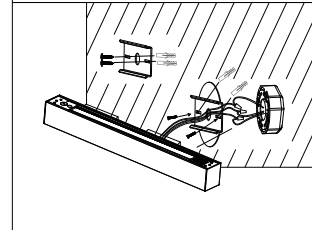

## Surface mounted installation

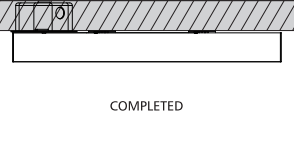
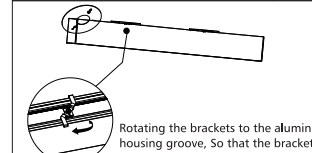
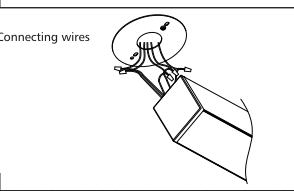
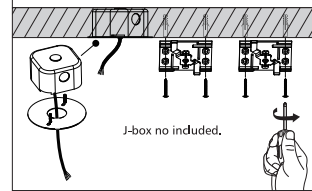
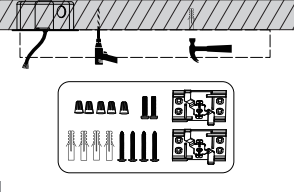
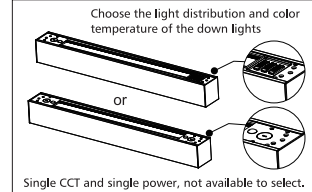

### COMPLETED