

VALA M1 1.8" Pendant Linear Light

DROP CEILING

► POWER FEED

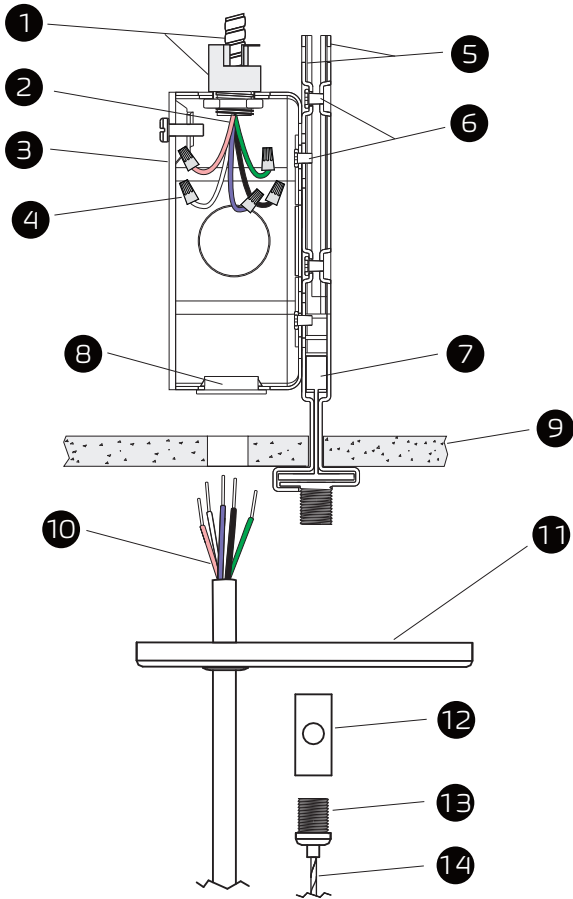

► NON POWER SUSPENSION

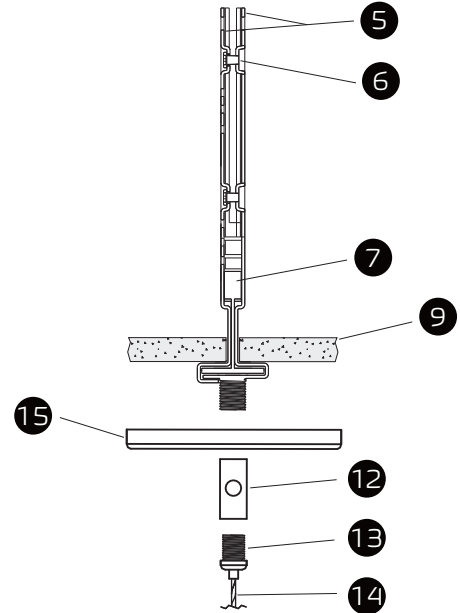

► PARTS LIST

- 1 Armored Cable & Connector (By Others)
- 2 Power Cord (By Others)
- 3 4" Octogon Junction Box
- 4 Wire Nut
- 5 Assembled T-grid Clips
- 6 Screw 6#*4
- 7 T-grid (By Others)
- 8 Plastic Grommet
- 9 Ceiling Tile (By Others)
- 10 Power Cord
- 11 4" Canopy Power Feed
- 12 Cable Holder
- 13 Strain Relief Thread Nut
- 14 Aircraft Cable
- 15 2" Canopy

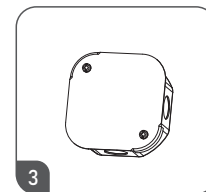

4" Octogon Junction Box

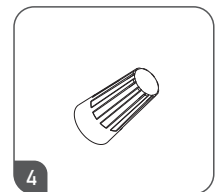

Wire Nut

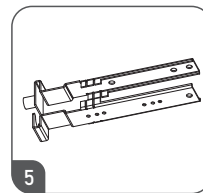

Assembled T-grid Clips

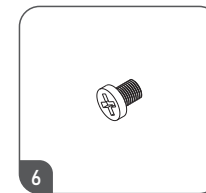

Screw 6#*4

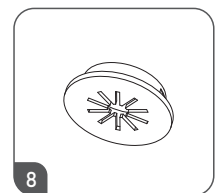

Plastic Grommet

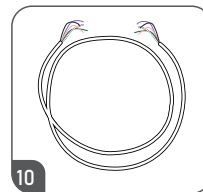

Power Cord

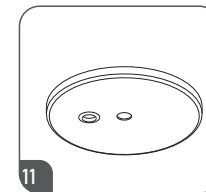

4" Canopy Power Feed

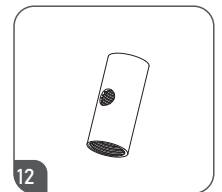

Cable Holder

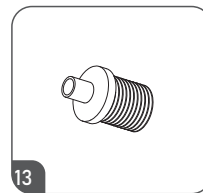

Strain Relief Thread Nut

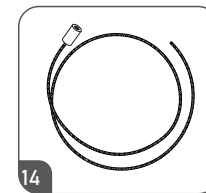

Aircraft Cable

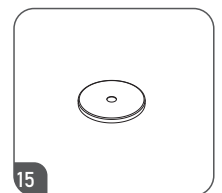

2" Canopy

VALA M1 1.8" Pendant Linear Light

DRY CEILING

▶ POWER FEED

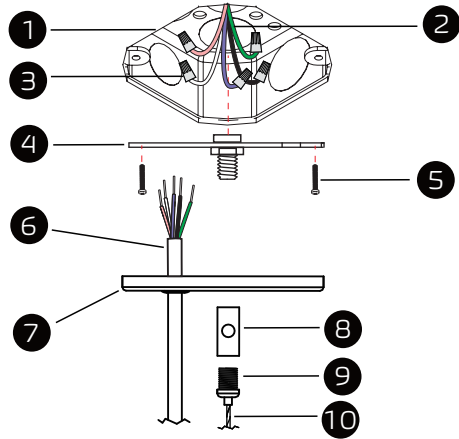

▶ NON POWER SUSPENSION

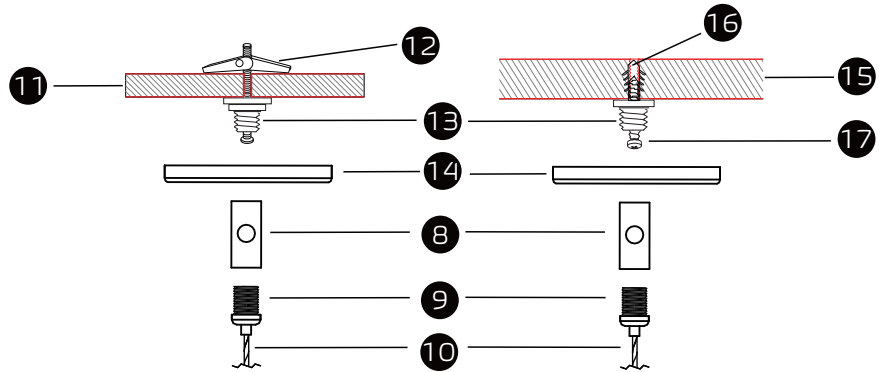

▶ PARTS LIST

- 1 4" Octagon Junction Box (By Others)
- 2 Power Cord (By Others)
- 3 Wire Nut
- 4 Junction Box Crossbar
- 5 Screw PM4*22
- 6 Power Cord
- 7 4" Power Canopy Kit
- 8 Cable Holder
- 9 Strain Relief Thread Nut
- 10 Aircraft Cable
- 11 Drywall Ceiling (By Others)
- 12 Butterfly Drywall Anchor
- 13 Crimp Stud
- 14 2" Canopy
- 15 Solid Ceiling (By Others)
- 16 Anchor
- 17 Screw PA4*30

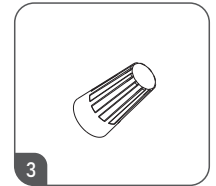

Wire Nut

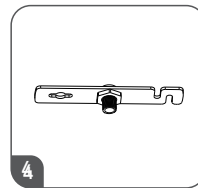

Junction Box Crossbar

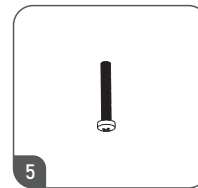

Screw PM4*22

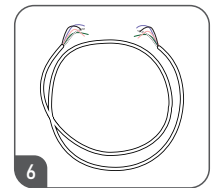

Power Cord

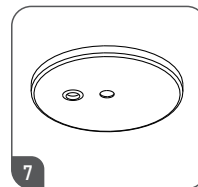

4" Canopy Power Feed

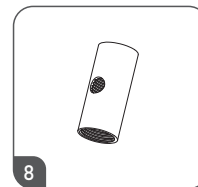

Cable Holder

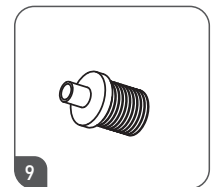

Strain Relief Thread Nut

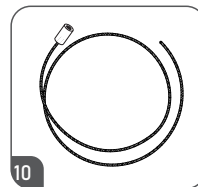

Aircraft Cable

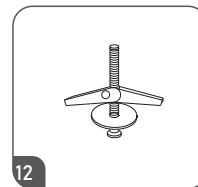

Butterfly Drywall Anchor

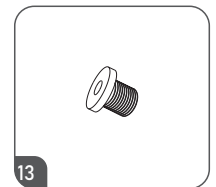

Crimp Stud

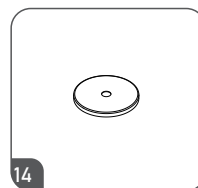

2" Canopy

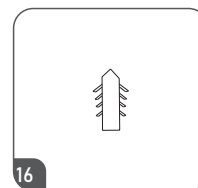

Anchor

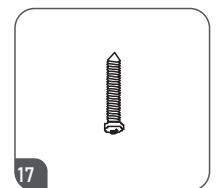

Screw PA4*30

VALA M1 1.8" Pendant Linear Light

IMPORTANT

1. Read all instructions.
2. Install in accordance with national and local electrical code regulations.
3. This product is intended to be installed and serviced by a qualified, licensed electrician.
4. Do not install in wet locations. For dry and damp use only.
5. Turn off electrical power before installing or servicing fixture in any way.
6. To reduce the risk of fire and overheating, make sure all connections are tight.
7. Under no circumstances can the lighting fixture be covered with heat insulation gasket or similar materials.
8. The maximum connection of each input line is 40FT(1200CM) in 120AC, 80FT (2400CM) in 230AC, 100FT(3000CM) in 277AC.

SHOCK HAZARD

 May result in serious injury or death. Turn power OFF at circuit breaker prior to installation or servicing.

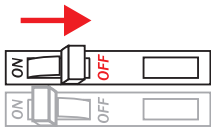

PRE-INSTALLATION

Assemble Power Cord

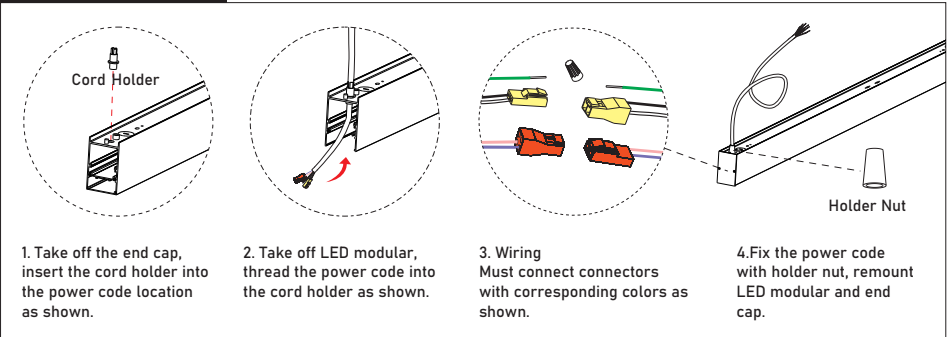

INDEPENDENT INSTALLATION

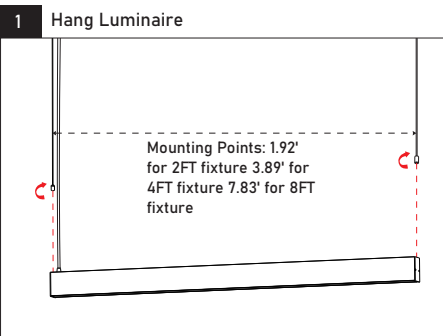

Screw both bottom parts of aircraft cables clockwise and secure then on the top of housing making sure they hang the lights.

Note: Adjust the height of luminaire. Luminaire can be raised by pulling cable through the gripper and can be lowered by depressing the top cylinder on the gripper which pulls the luminaire down.

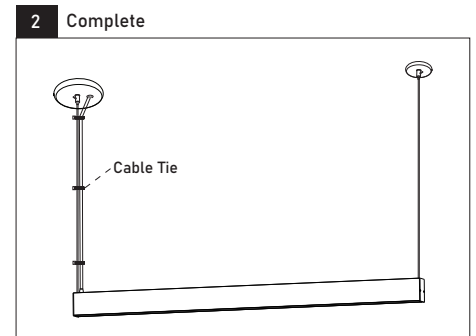

Use the cable tie to keep the electric wire going up along with the wire rope.

WIRING

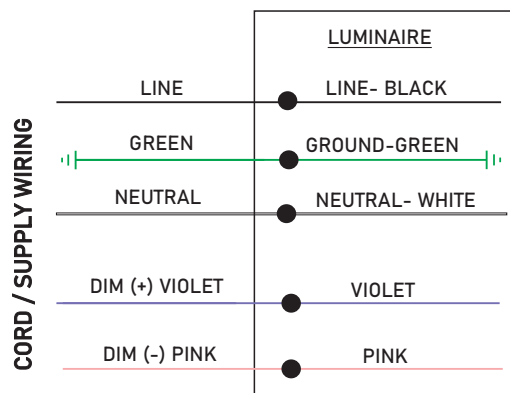

Please isolate two dimming wires by P2 terminal individually if no need dimming;
MUST connect wires with corresponding colors as shown.

VALA M1 1.8" Pendant Linear Light

JOINER OPTIONS

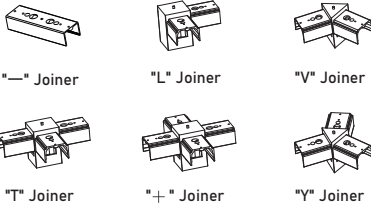

Noted: It needs 2 inputs if using joiner "T", " "and "+" "Y".

ACCESSORY



Noted: Silicone Seal is used to seal seams that may appear at both ends of luminaires when multiple connections.

BEFORE CONNECTING

Disassemble luminaires

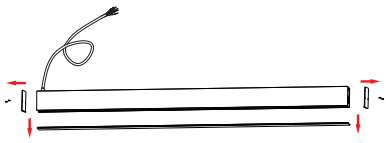

Start of run (SoR):

Take off both end caps and PC diffuser, assemble the power cord according to page 3.



Middle of run (MoR):

Take off both end caps and PC diffuser

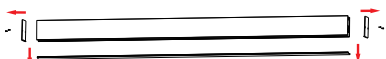

End of run (EoR):

Take off both end caps and PC diffuser

LINE CONNECTION

1 Hang luminaire and wiring - SoR

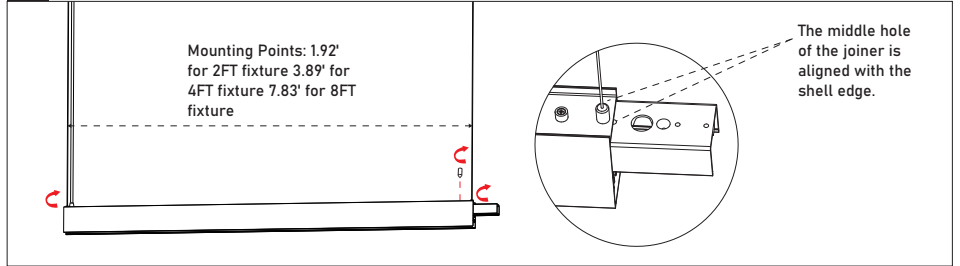

1-1: Screw both bottom parts of aircraft cables clockwise and secure them on the top of housing making sure they hang the lights.

1-2: Insert the joiner "-" into luminaire from one side and fix it with screws.

▲ Adjust the height of luminaire.

Luminaire can be raised by pulling cable through the gripper and can be lowered by depressing the top cylinder on the gripper which pulls the luminaire down.

2 Repeat Hang and join steps - MoR to EoR

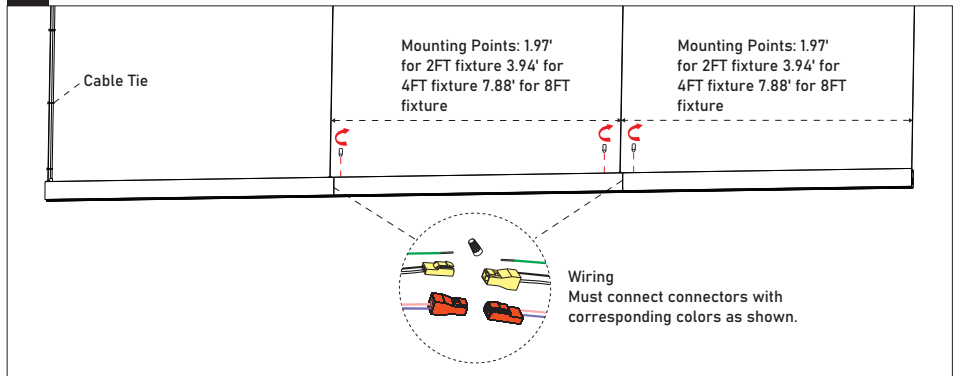

2-1: Connect the quick connectors properly.

2-2: Zip tight power cord & aircraft suspension cable with the cable tie.

3 Reload diffusers and end caps

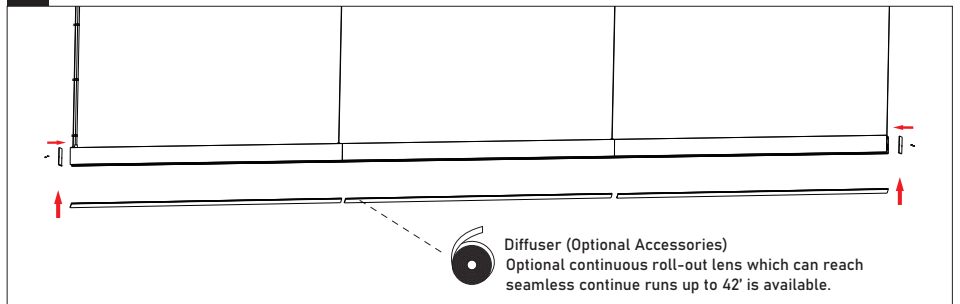

3-1: Reload the PC diffusers into the housing in turn. 3-2: Reload the end caps and fix with screws.

4 Complete

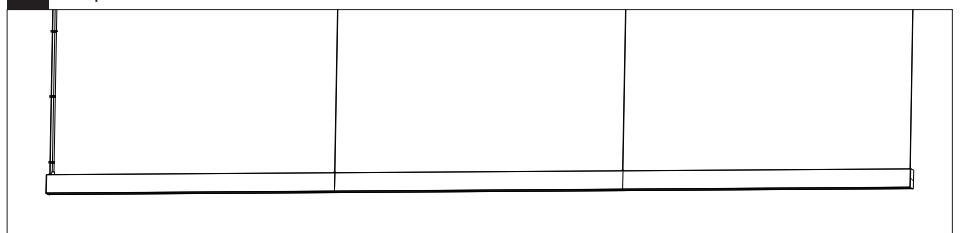

VALA M1 1.8" Pendant Linear Light

L SHAPE CONNECTION

- ▲ For "T", " +", "Y" shape or other geometric shapes, all subject to the "L" shape installation
- ▲ It needs 2 inputs if using joiner "T", " + and "Y".

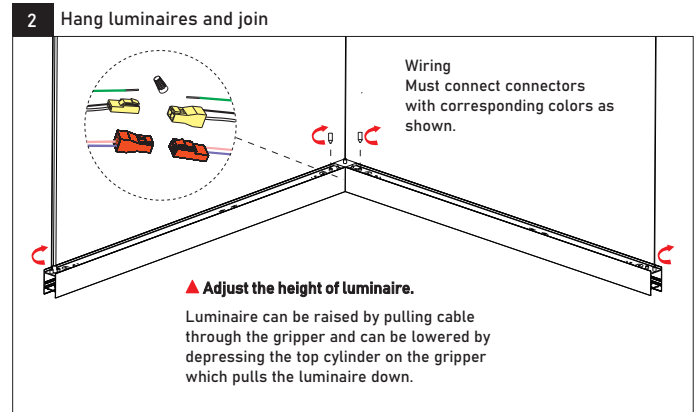
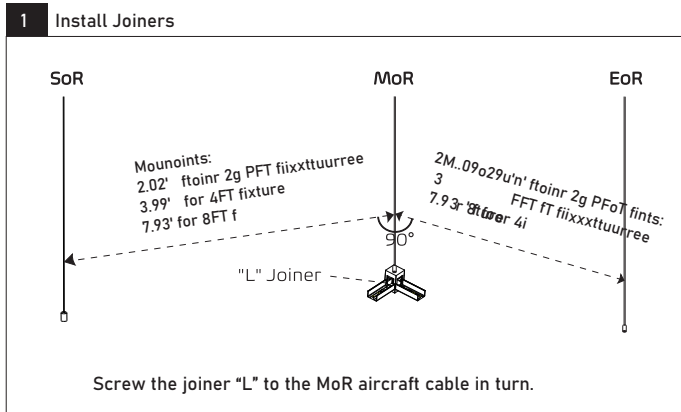

2-1: Screw aircraft cables clockwise and secure then , making sure they hang the lights. 2-2: Insert the joiner "L" into housing, and connect the quick connectors properly 2-3: Fix the joiner to the housing with screws.

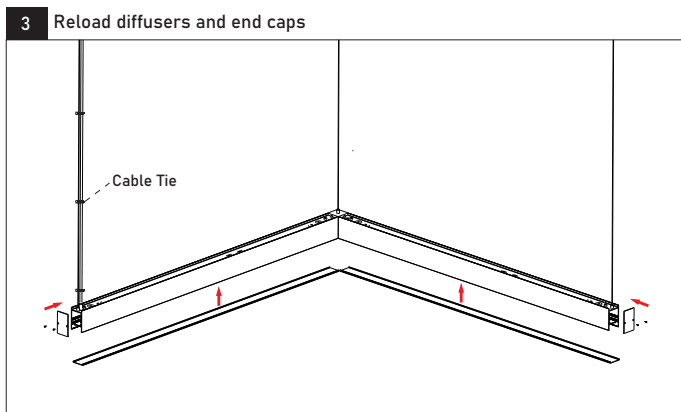

3-1: Zip tight power cord & aircraft suspension cable with the cable tie.
3-2: Rload the PC diffusers into the housing and fix the end caps with screws.

