

WPLN2 LED Selectable Full Cutoff Wall Pack Light

APPLICATIONS

The WPLN2 is a LED full cutoff wall pack featuring 4 selectable lumen outputs and 3 selectable CCT color outputs. This budget friendly, contractor experience LED wall pack features a pre-installed, low-voltage photocell installed directly to the driver, additionally the heat -sink fins just for the LED module - increasing the total performance lifespan, and shipped in an "anti-crush" advanced box. Selectable lumen range: 2,700 - 14,900 lm Selectable CCT range: 3000K, 4000K and 5000K

UL Listing

Suitable for wet locations

Replacement

Replaces 175W MH - 400W MH



38W & 65W



100W



ORDERING INFORMATION



EXAMPLE: WPLN2 38W LCS BZ UNV

Series	Wattage Selectable	CCT Selectable	Finish	Voltage	Options
WPLN2	17W - 2,789 lm	LCS 3000K 4000K 5000K	BZ Dark Bronze	UNV 120-277V	Blank
	23W - 3,698 lm				No Accessories
	31W - 4,871 lm				PCTM
	38W - 5,691 lm				Integrated Mini photocell (default)
	24W - 4,043 lm				EB8*
	35W - 5,783 lm				8W emergency battery for 38W and 65W
	49W - 7,873 lm				
	65W - 9,817 lm				
	43W - 6,668 lm				
	62W - 9,549 lm				
	84W - 12,725 lm				
	100W - 14,950 lm				

*Emergency battery only for 38W and 65W

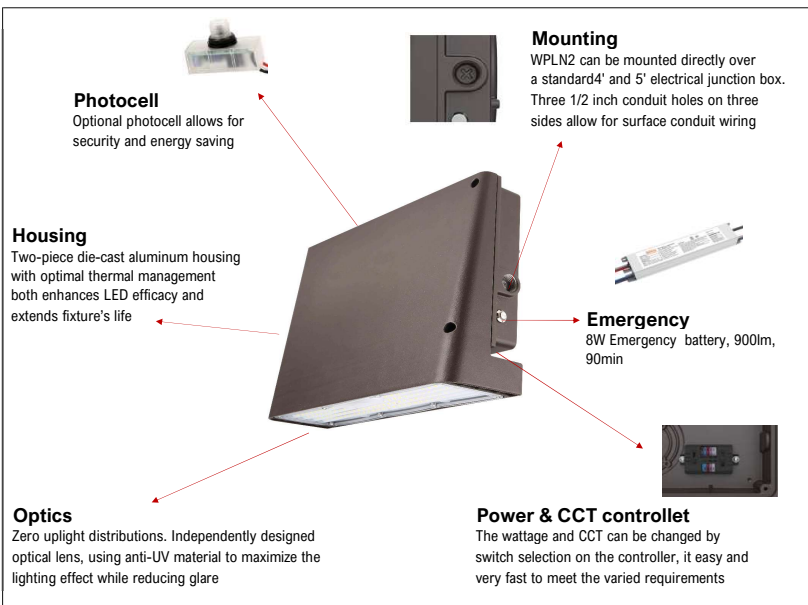



SPECIFICATIONS

ELECTRICAL

High quality constant-current drivers >90% efficiency and rated for 50/60Hz operation with Standard 120-277V input. 1-10V dimming

LIFESPAN

50,000 – hour LED lifespan based on IES LM-80 results and TM-21 calculations.

OPTICS

Anti-UV prismatic translucent lens designed to shape the light distribution and uniformity

MOUNTING

Can be mounted directly over a standard electrical junction box

CCT SELECTABLE

3000K / 4000K / 5000K; 70+ CRI

LUMENS SELECTABLE

Selectable lumen packages ranging from 2,700 - 9,800 lm for a small wall pack light
6,600 - 14,900 lm for a medium wall pack light

EFFICACY

Up to 148 lumens per watt

AMBINET TEMPERATURE

Suitable for use in -40°F to 104°F (-40°C to 40°C)

HOUSING

Two-piece die-cast aluminum housing secures the thermally conductive LED panel and electrical chamber. Separate heat-sink fins for LED module for increased performance life time.

FINISH

Formulated for high-durability and long-lasting color
Polyester Powder Dark Bronze coat

GREEN TECHNOLOGY

Mercury and UV-free. RoHS compliant components.
Polyester powder coat finish formulated without the use of VOCs or toxic heavy metals

WARRANTY

5 year limited warranty. Comprehensive warranty terms can be located on www.orelighting.com

DIMENSIONS

unit: mm / inch

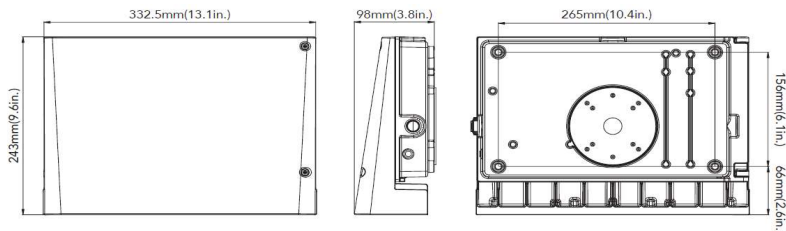

Small Size: 38W, 65W

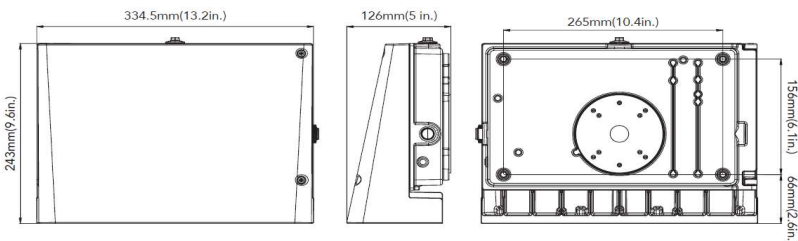

Medium Size: 100W

Product	L	W	H	Weight
WPLN2 - 38/65	13.1"	9.6"	3.8"	5.3 lbs
WPLN2 - 100	13.2"	9.6"	5.0"	5.8 lbs

PERFORMANCE DATA

PART NUMBER	WATTAGE	EFFICACY	3000K	4000K	5000K
			LUMENS	LUMENS	LUMENS
WPLN2-38	38W	147 lm/W	5600 lm	6000 lm	5700 lm
WPLN2-65	65W	146 lm/W	9500 lm	10000 lm	9700 lm
WPLN2-100	100W	148 lm/W	14800 lm	15500 lm	15000 lm

ADJUSTABLE LUMEN

POWER	VOLTAGE	38W		65W		100W	
		WATTS	LUMENS	WATTS	LUMENS	WATTS	LUMENS
40%	120-277V	17W	2789 lm	24W	4043 lm	43W	6668 lm
60%		23W	3698 lm	35W	5783 lm	62W	9549 lm
80%		31W	4871 lm	49W	7873 lm	84W	12726 lm
100%		38W	5691 lm	65W	9817 lm	100W	14951 lm

OPTIONS



EMERGENCY BACK UP BATTERY (SOLD SEPARATELY)

YH28A-08WL-180

8W Emergency Backup Battery LED Driver, 900 lm, 90 min



MINI PHOTOCELL (Default)

PCTM

MS-PUNVC01

Rated Voltage: 120-277V

Frequency: 50/60 Hz

ORE | OUTDOOR